



PIERSON MOTORS

mpierson@piersonmotors.ca 1-519-395-2424

2065 Concession 12, Ripley, ON N0G 2R0

Local 1-519-395-2424 | Fax 1-519-395-4141 | <https://www.piersonmotors.ca/>



2018 COACHMEN CLIPPER SINGLE AXLE 16FB

\$14,995.00

SPECIFICATIONS

Year	2018
Manufacturer	COACHMEN
Brand	CLIPPER SINGLE AXLE
Model	16FB
Type	Travel Trailer
Status	PreOwned
Stock #	p3042a
Financing Available	✖
Warranty Available	✖
Suspension	N/A
Leveling	N/A
Exterior Length	18.3 ft.
Dry Weight	2777 lbs.
Sleeping Capacity	4 person(s)
Interior Colour	N/A
Exterior Colour	Aluminum
Slideouts	N/A

Disclaimer: Product information, pricing and photos are as accurate as possible and are subject to change without notice.

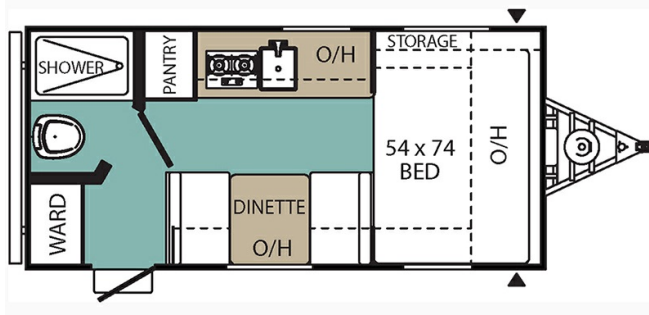

SELLING FEATURES

Specifications and Features:

- Length (ft): 18'4"
- Width (ft): 7'4"
- Height (ft): 9'8"
- Interior Height (ft): 6'4"
- GVWR (lbs): 3718
- Dry Weight (lbs): 2777
- Payload Capacity (lbs): 1018
- Hitch Weight (lbs): 318
- Number Of Fresh Water Holding Tanks: 1
- Total Fresh Water Tank Capacity...

OPTIONS & EQUIPMENT

- PAINT & FINISH
- SPECIAL PACKAGE
- ELECTRICAL

Powered by focusRV