



## WOODY'S RV WORLD EDMONTON

webleads@woodysrvedmonton.dsmessage.com 1-800-798-3380  
14510 Mark Messier Trail NW, Edmonton, AB T6V 1H5  
Local 1-780-455-3380 | Fax 1-780-455-3037 | <https://www.woodysrv.com/>



### ON ORDER UNIT

### Woody's Price

## 2025 GRAND DESIGN REFLECTION 100 28RL

### SPECIFICATIONS

|                     |                |
|---------------------|----------------|
| Year                | 2025           |
| Manufacturer        | GRAND DESIGN   |
| Brand               | REFLECTION 100 |
| Model               | 28RL           |
| Type                | Fifth Wheel    |
| Status              | New            |
| Stock #             | 50238          |
| Financing Available | ✓              |
| Warranty Available  | Manufacturer   |
| Suspension          | N/A            |
| Leveling            | N/A            |
| Exterior Length     | 31.0 ft.       |
| Dry Weight          | 8362 lbs.      |
| Sleeping Capacity   | 4 person(s)    |
| Interior Colour     | COLLINS        |
| Exterior Colour     | Fiberglass     |
| Slideouts           | 2              |

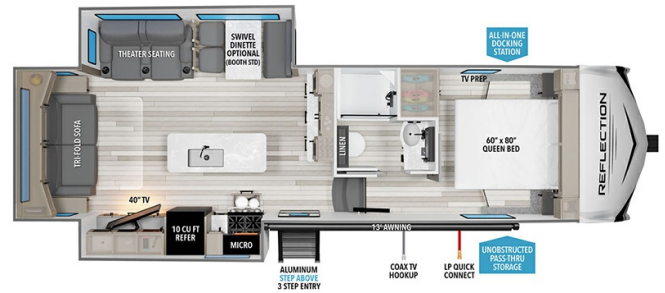

**Disclaimer:** Product information, pricing and photos are as accurate as possible and are subject to change without notice.

### SELLING FEATURES

#### Specifications and Features:

- Length (ft): 31'0"
- Width (ft): 8'0"
- Height (ft): 12'3"
- GVWR (lbs): 10995
- Dry Weight (lbs): 8362
- Payload Capacity (lbs): 2633
- Hitch Weight (lbs): 1348
- Number Of Fresh Water Holding Tanks: 1
- Total Fresh Water Tank Capacity (gal): 55
- Number Of Gra...

### OPTIONS & EQUIPMENT

- PEACE OF MIND PACKAGE
- ULTIMATE POWER PACKAGE
- ARCTIC 4-SEASON PACKAGE
- SOLAR PACKAGE
- GOODYEAR TIRES
- ABS AXLE ASSEMBLY W/SWAY CONTROL
- WINTERIZATION
- SAFERIDE RV ROADSIDE ASSISTANCE
- SWIVLE DINETTE W/ 2 CHAIRS & OTTOMAN
- 2ND A/C, 13.5K BTU DUCTED
- RVIA SEAL
- WOODY'S VOLUME DISCOUNT

Powered by focusRV