

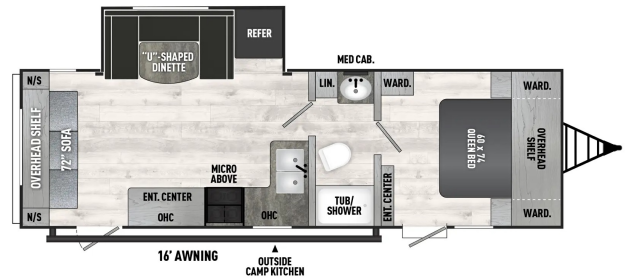

**SPECIAL UNIT**
**\$35,900.00**

Originally \$42,900

**\$196 Bi-Weekly**
**2024 COACHMEN CLIPPER 272RLS**
**SPECIFICATIONS**

|                     |                |
|---------------------|----------------|
| Year                | 2024           |
| Manufacturer        | COACHMEN       |
| Brand               | CLIPPER        |
| Model               | 272RLS         |
| Type                | Travel Trailer |
| Status              | New            |
| Stock #             | 8554           |
| Financing Available | ✓              |
| Warranty Available  | ✓              |
| Suspension          | N/A            |
| Leveling            | N/A            |
| Exterior Length     | 26.0 ft.       |
| Dry Weight          | 6012 lbs.      |
| Sleeping Capacity   | 5 person(s)    |
| Interior Colour     | N/A            |
| Exterior Colour     | Aluminum       |
| Slideouts           | 1              |



**Disclaimer:** Product information, pricing and photos are as accurate as possible and are subject to change without notice.

**SELLING FEATURES**

The 272RLS features a large open-space concept rear living with both a jack-knife sofa, u-dinette, and private front-end bedroom. The front bedroom is the industry's largest non-slide master bedroom in a conventional travel trailer. The non-camping side features a u-dinette plus an extra-large 11...

Powered by focusRV