



## CLEARANCE UNIT

# \$29,500.00

## \$156 Bi-Weekly

### 2021 SPORTSMEN CLASSIC LE 261RLLE

#### SPECIFICATIONS

Year	2021
Manufacturer	SPORTSMEN CLASSIC
Brand	LE
Model	261RLLE
Type	Travel Trailer
Status	PreOwned
Stock #	091032
Financing Available	✓
Warranty Available	✓
Suspension	N/A
Leveling	N/A
Exterior Length	28.5 ft.
Dry Weight	5860 lbs.
Sleeping Capacity	6 person(s)
Interior Colour	N/A
Exterior Colour	Aluminum
Slideouts	1

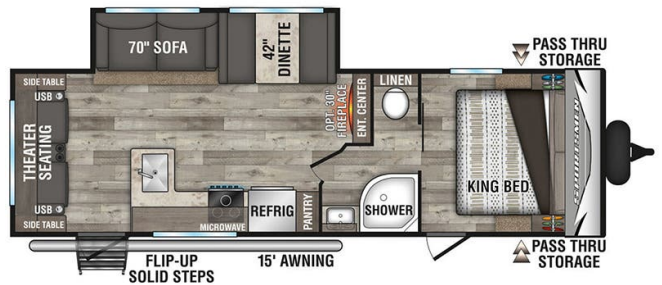

**Disclaimer:** Product information, pricing and photos are as accurate as possible and are subject to change without notice.

#### SELLING FEATURES

Preowned couples travel trailer with big kitchen and living room area in excellent condition:

Features:

- Sleeps up to 6 - front queen bed, the dinette and couch that folds down in to a bed
- Kitchen includes fridge/freezer, microwave, range, sink and storage
- Bathroom with shower, toilet, sink and storage
- Furnace and A/C
- Spare tire, carrier, and cover
- Includes deep cycle battery and propane tanks
- Dry weight of 5,860lbs

No hidden fees (freight, PDI, licensing, admin, or battery fee). Simply add the HST!

Financing available.

#### OPTIONS & EQUIPMENT

- Pre-delivery Inspection
- Deep Cycle RV Battery
- Propane Tank(s)
- Licensing Completed
- Electrical Adaptor
- 25' Water Hose
- 10' Sewer Hose
- Thorough Walkthrough