



2025 FOREST RIVER SALEM 29VBUD

\$47,900.00

\$224 Bi-Weekly

SPECIFICATIONS

Year	2025
Manufacturer	FOREST RIVER
Brand	SALEM
Model	29VBUD
Type	Travel Trailer
Status	New
Stock #	337973
Financing Available	✓
Warranty Available	✓
Suspension	N/A
Leveling	N/A
Exterior Length	34.2 ft.
Dry Weight	7889 lbs.
Sleeping Capacity	10 person(s)
Interior Colour	N/A
Exterior Colour	Aluminum
Slideouts	1

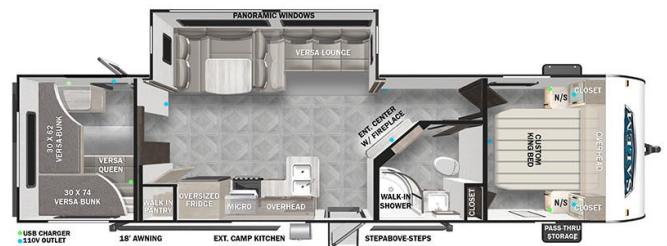

Disclaimer: Product information, pricing and photos are as accurate as possible and are subject to change without notice.

SELLING FEATURES

The 29VBUD is ready to impress with versatile bunkhouse and lots of space!

Features:

- **Best in Class Value Package:** Versa-Tilt Bed, 200W Solar Panel w/30 Amp Controller, Upgraded Designer Furniture Package, 20.3 CU FT of Stow N Go Storage, Versa Lounge (Select Models), MORryde™ StepAbove Double Step (Main Door Only), Exterior LED Light Strip Under Awning, Modern Cloth Roller Shades w/ AutoStop, Green Pkg: Roof Mount Solar Prep & LED Mushroom Lights, Power Awning w/ Adjustable Legs, Quick Drop Stabilizer Jacks, Power Tongue Jack w/ LED Light, Stainless Steel Roll Up Sink Cover, Ext. Convenience PKG: Friction Hinge & Baggage Door Magnets, Furion Backup Camera Prep, Large Capacity 11 CU FT Frost-Free Refrigerator (12-volt, Slide-Out Awning Prep, Black Tank Flush, Seamless Countertops (No T-Mold), Designated CPAP Storage
- Sleeps up to 10- front custom king bed, rear bunkroom that sleeps four, and a versa lounge that folds down to a bed
- Kitchen includes stainless steel fridge/freezer, microwave, and range/oven
- Outside kitchen with griddle and mini bar fridge
- Bathroom includes shower, vanity, toilet, and skylight
- Entertainment center with stereo, TV hookups, fireplace and indoor/outdoor speakers
- Spare tire, carrier, and cover
- Includes deep cycle marine battery and propane tanks
- Full manufacturer's warranty
- Dry weight of 7,889lbs

No hidden fees (freight, PDI, licensing, admin, or battery fee). Simply add the HST! Financing available.

OPTIONS & EQUIPMENT

- Pre-delivery Inspection
- Deep Cycle RV Battery
- Propane Tank(s)
- Licensing Completed
- Electrical Adaptor
- 25' Water Hose
- 10' Sewer Hose
- Thorough Walkthrough

Powered by focusRV