



WOODY'S RV WORLD RED DEER

webleads@woodysrvreddeer.dsmessage.com 1-800-267-8253

71 Burnt Park Drive, Red Deer, AB T4P 0J7

Local 1-403-346-1130 | Fax 1-403-341-4380 | <https://www.woodysrv.com/>



MSRP \$568,980.00

Woody's Price

2022 FLEETWOOD DISCOVERY 38N

SPECIFICATIONS

Year	2022
Manufacturer	FLEETWOOD
Brand	DISCOVERY
Model	38N
Type	Motorhome
Class	A
Fuel Type	Diesel
Status	PreOwned
Stock #	49590
Financing Available	✓
Warranty Available	For Purchase
Odometer	12695 kms.
VIN	4UZACGFC5NCNR4804
Chassis	Freightliner Freedom Bridge®
Engine	360HP I6 Diesel Pusher
Transmission	AUTO
Suspension	N/A
Leveling	N/A
Exterior Length	38.7 ft.
Dry Weight	33400 lbs.
Sleeping Capacity	9 person(s)
Interior Colour	ENCLAVE/HEARITAGE
Exterior Colour	Fiberglass
Slideouts	3

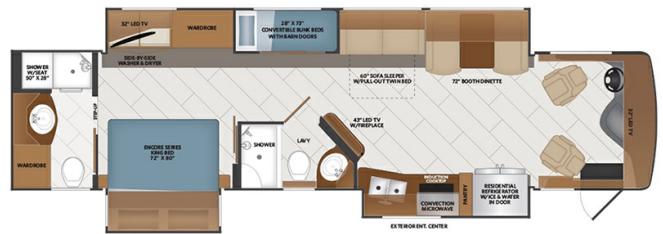

Disclaimer: Product information, pricing and photos are as accurate as possible and are subject to change without notice.

SELLING FEATURES

Specifications and Features:

- Chassis Brand: Freightliner
- Engine Type: I6 Diesel Pusher
- Chassis Model: Freedom Bridge®
- Cylinders: 6
- Horsepower (bhp): 360
- Torque (Ft Lbs): 800
- Fuel Type: Diesel
- Transmission Brand: Allison
- Transmission Type: Automatic
- Number Of Speeds: 6
- Dr...

OPTIONS & EQUIPMENT

- FREIGHTLINER CHASSIS 360HP CUMMINS
- DISHWASHER
- PWR PASSENGER SEAT W/PWR FOOTREST
- MOTION POWER LOUNGE
- DROP DOWN BED - ELECTRIC
- THIRD ROOF A/C
- OCEANFRONT COLLECTION
- BRAKESYNC FCCC
- TECH PKG (WIFI EXT W/LTE, CELL BOOST, 300W SOLAR, COLLISION MIT, FIREFLY)
- RVIA CERTIFICATION TAG
- FIBERGLASS FRONT & REAR CAPS
- TUFF COAT SOLID FBGLS ROOF
- ONE PIECE TPO ROOF
- 105 GAL FRESH WATER SYSTEM
- 50 GAL WASTE TANK
- 75 GAL GREY WATER TANK

- SANI-FLUSH SYSTEM
- BATH SKYLIGHT
- 12V BATH & GALLEY VENT
- FULL BODY PAINT
- ALUM FRAME WALLS,FLR,CEILING
- EXTERIOR LADDER
- SIDE HINGE LUGGAGE DOORS
- FREEDOM BRIDGE CONSTRUCTION
- PATIO AWNING, ELEC W/LED
- AUTOMATIC LEVELING JACKS
- TRAILER HITCH
- ELEC DOUBLE ENTRY STEP
- AIR HORNS
- REMOTE HD MIRRORS W/ CAMERA
- SATELLITE RADIO READY
- 10" TOUCH SCREEN DASH RADIO
- EXT. ENTERTAINMENT CENTER
- SOUNDBAR
- TV ANTENNA
- BEDROOM LED TV
- MID SHIP LED TV
- REAR BACK-UP VIDEO CAMERA
- RESIDENTIAL REFER W/ ICE/WATER
- COOKTOP 2 BRNR INDUCTION
- DECORATIVE GALLEY BACKSPLASH
- MICROWAVE CONVECTION OVEN
- WASHER & DRYER
- STN STL DOUBLE GALLEY SINK
- MOLDED SHOWER ENCLOSURE
- GLASS SHOWER ENCLOSURE
- AQUA HOT HYDRONIC HEATING
- DUAL ROOF AIR CONDITIONERS
- AC/DC POWER INVERTER
- 120 VOLT POWER CORD
- 12 VOLT LED LIGHTS
- UNDERCHASSIS LIGHTING
- POWER WINDSHIELD BLIND
- SMOKE DETECTOR
- FIRE EXTINGUISHER
- ENERGY MANAGEMENT SYSTEM
- 50 AMP SERVICE
- 12V BATTERY DISCONNECT SWITCH
- AUXILIARY START CIRCUIT
- 8.0KW GENERATOR-DIESEL
- CO DETECTOR
- MANUAL DOUBLE ROLLER BLINDS
- DUAL GLAZED RADIUS WINDOWS
- ALUMINUM WHEELS
- TELESCOPIC/TILT STEERING WHEEL
- 3-POINT SEAT BELTS-DRV/PASS
- FOAM MATTRESS-KING
- SOLID SURFACE COUNTER TOPS
- HARDWOOD CABINET DOORS
- PORCELAIN TILE FLOORING
- HEATED TILE FLOOR
- SOFT TOUCH DRV/PASS RECL SEATS
- PDI

Powered by focusRV