

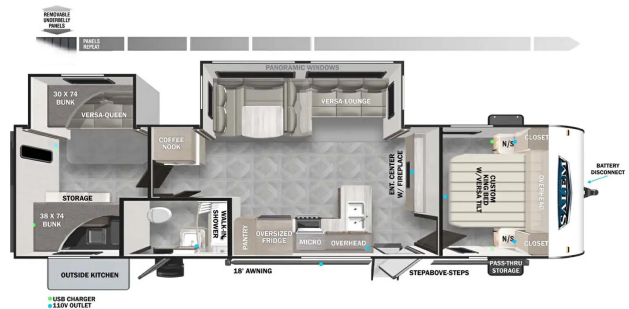

**SPECIAL UNIT**
**\$49,900.00**

Originally \$54,900

**\$239 Bi-Weekly**
**2024 FOREST RIVER SALEM 32BHDS**
**SPECIFICATIONS**

|                     |                |
|---------------------|----------------|
| Year                | 2024           |
| Manufacturer        | FOREST RIVER   |
| Brand               | SALEM          |
| Model               | 32BHDS         |
| Type                | Travel Trailer |
| Status              | New            |
| Stock #             | 337550         |
| Financing Available | ✓              |
| Warranty Available  | ✓              |
| Suspension          | N/A            |
| Leveling            | N/A            |
| Exterior Length     | 34.0 ft.       |
| Dry Weight          | 8385 lbs.      |
| Sleeping Capacity   | 10 person(s)   |
| Interior Colour     | N/A            |
| Exterior Colour     | Fiberglass     |
| Slideouts           | 2              |



**Disclaimer:** Product information, pricing and photos are as accurate as possible and are subject to change without notice.

**SELLING FEATURES**

Spacious double slide bunkmodel with outdoor kitchen!

Features:

- **Best in Class Value Package:** Versa-Tilt Bed, 200W Solar Panel w/30 Amp Controller, Upgraded Designer Furniture Package, 20.3 CU FT of Stow N Go Storage, Versa Lounge (Select Models), MORryde™ StepAbove Double Step (Main Door Only), Exterior LED Light Strip Under Awning, Modern Cloth Roller Shades w/ AutoStop, Green Pkg: Roof Mount Solar Prep & LED Mushroom Lights, Power Awning w/ Adjustable Legs, Quick Drop Stabilizer Jacks, Power Tongue Jack w/ LED Light, Stainless Steel Roll Up Sink Cover, Ext. Convenience PKG: Friction Hinge & Baggage Door Magnets, Furrion Backup Camera Prep, Large Capacity 11 CU FT Frost-Free Refrigerator (12-volt, Slide-Out Awning Prep, Black Tank Flush, Seamless Countertops (No T-Mold), Designated CPAP Storage
- Sleeps up to 10- front reclining king bed, rear bunk room, and couch and dinette that fold down to beds
- 200 watt roof-mounted solar panel
- Kitchen includes fridge/freezer, microwave, oven, stovetop with cover
- Outdoor kitchen with bumper mounted bbq, bar fridge, sink and storage
- Bathroom with shower, vanity and toilet
- Furnace and ducted A/C
- Spare tire, carrier, and cover
- Includes deep cycle marine battery and propane tanks
- Manufacturer warranty
- Dry weight of 8,385lbs

No hidden fees (freight, PDI, licensing, admin, or battery fee). Simply add the HST! Financing available.

**OPTIONS & EQUIPMENT**

- Pre-delivery Inspection
- Deep Cycle RV Battery
- Propane Tank(s)
- Licensing Completed
- Electrical Adaptor
- 25' Water Hose
- 10' Sewer Hose
- Thorough Walkthrough