



2023 THOR ACE. 29G

\$159,986.00

Originally \$207,895.00

\$637 Bi-Weekly

SPECIFICATIONS

Year	2023
Manufacturer	THOR
Brand	ACE.
Model	29G
Type	Motorhome
Class	A
Fuel Type	Gas
Status	PreOwned
Stock #	48099A
Odometer	3752 kms.
VIN	AAR029G0050275
Chassis	Ford F53
Engine	350HP V8
Transmission	AUTO
Suspension	N/A
Leveling	N/A
Exterior Length	30.8 ft.
Dry Weight	18000 lbs.
Sleeping Capacity	8 person(s)
Interior Colour	N/A
Exterior Colour	Fiberglass
Slideouts	2

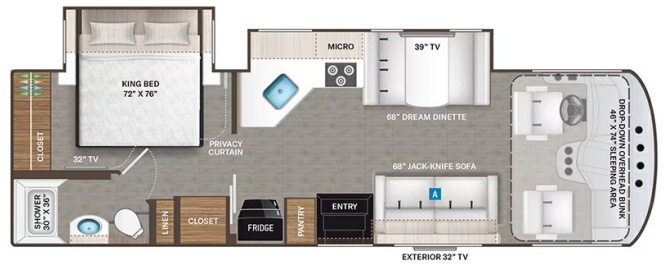

Disclaimer: Product information, pricing and photos are as accurate as possible and are subject to change without notice.

SELLING FEATURES

Specifications and Features:

- Chassis Brand: Ford
- Engine Type: V8
- Chassis Model: F53
- Cylinders: 8
- Horsepower (bhp): 350
- Torque (Ft Lbs): 468
- Fuel Type: Gas
- Transmission Brand: TorqShift
- Transmission Type: Automatic
- Number Of Speeds: 6
- Driveline Type: 4X2
- Length (ft): 30...