



CLEARANCE UNIT

\$19,992.00

Originally \$40,990.00

2024 FOREST RIVER CHEROKEE WOLF PUP 16FQW

SPECIFICATIONS

Year	2024
Manufacturer	FOREST RIVER
Brand	CHEROKEE WOLF PUP
Model	16FQW
Type	Travel Trailer
Status	New
Stock #	R9139024
Financing Available	✓
Warranty Available	✓
Suspension	N/A
Leveling	N/A
Exterior Length	21.8 ft.
Dry Weight	3619 lbs.
Sleeping Capacity	3 person(s)
Interior Colour	N/A
Exterior Colour	Aluminum
Slideouts	N/A

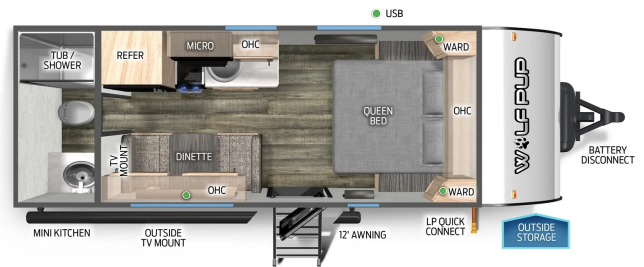

Disclaimer: Product information, pricing and photos are as accurate as possible and are subject to change without notice.

SELLING FEATURES

Specifications and Features:

- Length (ft): 21'10"
- Width (ft): 7'6"
- Height (ft): 10'6"
- GVWR (lbs): 5545
- Dry Weight (lbs): 3619
- Payload Capacity (lbs): 1926
- Hitch Weight (lbs): 445
- Number Of Fresh Water Holding Tanks: 1
- Total Fresh Water Tank Capacity (gal): 26
- Number Of Gray...

OPTIONS & EQUIPMENT

BRYCE CANYON DECOR

JUICE PACK WITH 100 WATT SOLAR PANEL

JUICE PACK EXPANSION KIT

LIMITED PACKAGE:

- 13 500 BTU Air Conditioner
- 14" Premium Wheel Package
- 20 000 BTU Furnace
- 12V High Efficiency 11 Cubic Foot Residential Refrigerator with Travel Lock
- Cherokee Back up Camera System
- Cherokee Exclusive Stable Step with Oversized Landing
- Detachable Power Cord
- Exterior LED Light Strip at Awning
- External Porch Scare Light
- Flushmount Range with Cover
- Four Stabilizer Jacks
- LED Interior Lights
- Interior & Exterior Ghost Lights
- Night Shades
- Exclusive Solar Thermo Controlled Reflective Tinted Safety Glass Windows
- Outside Shower with Hot and Cold Water
- Power Awning

- Power Gear™ Frame Technology and Space Saver Rail Design
- Real Blackout Glass Safety Slam Friction Hinge Entry Door with Window and Shade Prep
- Seamless Countertop
- Seamless Roofing Membrane with Heat Reflectivity
- Shower Tub Surround
- Spare Tire
- Inside and Outside Speakers
- Tire Pressure Monitors
- Tongue and Groove Plywood Flooring
- Upgraded Stainless Range Hood with Light and Fan
- USB charging stations (Beds Bunks Table where Applicable)
- Wolf Pup Quick Jack
- Removable Gaucho Brackets (RR Models Only)
- USB Charging Stations
- Ladder Prep

ADVANTAGE PACKAGE:

- 14" Tires for improved towing in place of 13"
- 26" Wide Door IPO 22" Door
- Aerodynamic Smooth Radius Front Profile
- Specialized Dispatch Services Roadside Assistance
- Exterior 110V Recept
- High Impact Front metal IPO corrugated metal
- Large Exterior Folding Assist Handle
- Monitor Panel for Tanks and Battery Levels
- Outside Storage Door
- Solar Prep and Wiring
- TV Antenna with Hookups

CAMPING PACKAGE:

- 55 Amp Converter
- Tankless Water Heater
- Bluetooth Radio
- Bathroom Fan
- Fiberglass Entry Door
- Foot Flush Toilet
- Full Length Awning
- High Flo Water Pump
- High Output Cooktop
- High Rise Faucet
- Large High Output Microwave
- Nitrogen Filled Tires
- One Piece Walkable Decked Roof
- Oversized Dinette with Removable Table

SAFETY PACKAGE:

- Carbon Monoxide Detector
- Emergency Exit Windows
- Fire Extinguisher
- GFI Protective Outlet
- LP Gas Detector
- Safety Glass Windows
- Smoke Detector

Powered by focusRV