



SPECIAL UNIT

\$119,995.00

Originally ~~\$175,493~~

\$290 Weekly

2024 EAST TO WEST AHARA 390DS

SPECIFICATIONS

Year	2024
Manufacturer	EAST TO WEST
Brand	AHARA
Model	390DS
Type	Fifth Wheel
Status	New
Stock #	390DS0780
Financing Available	✓
Warranty Available	✓
Suspension	N/A
Leveling	N/A
Exterior Length	42.1 ft.
Dry Weight	15258 lbs.
Sleeping Capacity	8 person(s)
Interior Colour	N/A
Exterior Colour	N/A
Slideouts	4

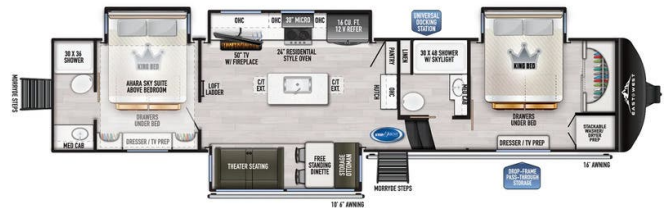

Disclaimer: Product information, pricing and photos are as accurate as possible and are subject to change without notice.

SELLING FEATURES

A fifth wheel with TWO king beds? Introducing the Ahara 390DS. With features such as two awnings, Azdel wall construction, solar ready, six point hydraulic levelling, residential appliances and pull out fireplace with extra storage below. This trailer can be towed by almost any three-quarter ton ...

OPTIONS & EQUIPMENT

Awning	Aluminum Wheels	Fridge with 2 doors	Heating	3 Air Conditioning Unit(s) (Ducted) - Size: 15000	Aux Battery	Battery Charger
Battery Tray	Solid Surface Counter Tops	Day Night Shades	Enclosed Underbelly	Fireplace	Fully Furnished	
Hide A Bed	Inverter	Island Bed	LPG Detector	Microwave	Convection Oven	
Monitor Panel	Power Air Vents	Power Bath Vents	Satellite Dish	Sky Light(s)	Smoke Detector	
Solar Panel	Toilet Facilities	1 Televisions	Plasma/LCD	Gas (dsi) Water Heater 6	Winterizing	
Secondary Awning - 12 ft						

Powered by focusRV