



GREAT ESCAPE RV

justin@greatescapervcanada.com 1-888-716-4542
RR42 - 24265 Richmond St. N, LONDON, ON N5X 4B2

Local 1-519-227-4700 | Fax 1-519-227-4788 | www.greatescapervcanada.com



CLEARANCE UNIT

\$54,995.00

\$336 Bi-Weekly

2018 FOREST RIVER Hemisphere GLX 337BAR

SPECIFICATIONS

Year	2018
Manufacturer	FOREST RIVER
Brand	Hemisphere GLX
Model	337BAR
Type	Fifth Wheel
Status	PreOwned
Stock #	U721
Financing Available	✓
Warranty Available	✓
Suspension	N/A
Leveling	Electric
Exterior Length	39.6 ft.
Dry Weight	10069 lbs.
Sleeping Capacity	4 person(s)
Interior Colour	Brown
Exterior Colour	Fiberglass
Slideouts	3

Disclaimer: Product information, pricing and photos are as accurate as possible and are subject to change without notice.

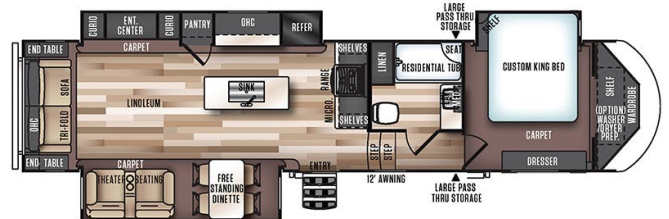

SELLING FEATURES

From luxurious fabrics to rich wood tones, the Salem Hemisphere is truly in a class of its own. Plus, you'll enjoy better gas mileage and a smoother ride with the wind-resistant design of the Hemisphere. The 337BAR is a Beautiful couples' unit, with a free-standing dinette, theater seating, tri-f...

OPTIONS & EQUIPMENT

Awning 12'	Fridge with 2 doors	Heating	1 Air Conditioning Unit(s) (Ducted) - Size: 13.5	Back Flush	AC/DC Converter	Solid Surface Counter Tops
Enclosed Underbelly	Free Standing Table	Fully Furnished	LPG Detector	Microwave	Monitor Panel	
Power Bath Vents	1 Sky Light(s)	Smoke Detector	Spare with Carrier	Toilet Facilities	Gas/Elec Water Heater 16G	
Power Awning	Power Stabilizer jacks	Rear Camera Prep	Solar Panel Prep			

