



SPECIAL UNIT

2025 KEYSTONE COUGAR HALF-TON 23MLE

SPECIFICATIONS

Year	2025
Manufacturer	KEYSTONE
Brand	COUGAR HALF-TON
Model	23MLE
Type	Fifth Wheel
Status	New
Stock #	T000007
Suspension	N/A
Leveling	N/A
Exterior Length	27.9 ft.
Dry Weight	7577 lbs.
Sleeping Capacity	6 person(s)
Interior Colour	N/A
Exterior Colour	Fiberglass
Slideouts	2

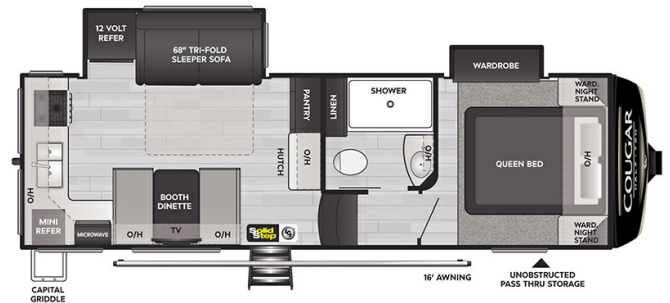

Disclaimer: Product information, pricing and photos are as accurate as possible and are subject to change without notice.

SELLING FEATURES

Specifications and Features:

- Length (ft): 27'11"
- Height (ft): 12'0"
- Dry Weight (lbs): 7577
- Payload Capacity (lbs): 2323
- Hitch Weight (lbs): 1200
- Number Of Fresh Water Holding Tanks: 1
- Total Fresh Water Tank Capacity (gal): 54
- Number Of Gray Water Holding Tanks: 1
- Total Gray ...

OPTIONS & EQUIPMENT

- PAINT & FINISH
- ELECTRICAL
- IDENTIFICATION
- INTERIOR
- PAINT & FINISH
- HVAC
- EXTERIOR