



SICARD RV



sales.leads.focusrv@sicardrv.com 1-800-688-2210

7526 Regional Road 20, West Lincoln, ON L0R 2A0

Local 1-905-957-3344 | Fax 1-905-957-7855 | www.sicardrv.com

SPECIAL UNIT

\$169,990.00

Originally \$194,990

\$784 Bi-Weekly

2023 WOODLAND PARK TIMBER RIDGE ST LAWRENCE TC-307C

SPECIFICATIONS

Year	2023
Manufacturer	WOODLAND PARK
Brand	TIMBER RIDGE
Model	ST LAWRENCE TC-307C
Type	Park Model
Status	New
Stock #	20808
Financing Available	✘
Warranty Available	✘
Suspension	N/A
Leveling	N/A
Exterior Length	44.0 ft.
Dry Weight	N/A lbs.
Sleeping Capacity	4 person(s)
Interior Colour	White Colville Beach / Sand Decor
Exterior Colour	Midnight Surf
Slideouts	N/A

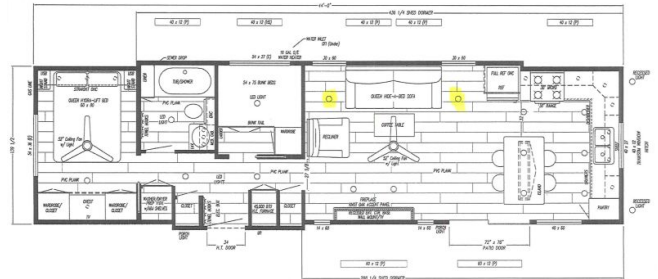

Disclaimer: Product information, pricing and photos are as accurate as possible and are subject to change without notice.

SELLING FEATURES

The 2023 Timber Ridge St. Lawrence TC-307C, by Woodland Park, is a home away from home. This park model home features a pull-out sofa bed, a kitchen island with barstools & sleeps up to 4 people. All Timber Ridges are backed with a 3 year manufacturer limited factory warranty. Start enjoying ever...

OPTIONS & EQUIPMENT

- PVC PLANK UPGRADE THATCH
- WALLBOARD WHITE COLVILLE BEACH
- CEILING BOARD MANSION FROST
- DOOR (REAR AND PATIO) AND WINDOW COLOR WHITE
- DOOR (REAR AND PATIO) & WINDOW NO GRIDS
- DOOR REAR HOUSE TYP FIBERGLASS W/STORM AND WINDOW
- INTERNAL BLIND FOR REAR DOOR (NO GRIDS)
- WINDOW VINYL LOW-E THERMOPANE
- WINDOW TRANSOM
- INSULATION (R13 WALLS / R21 CEILING)
- RADIANT FOIL FLOOR
- RADIANT FOIL SIDE WALLS, FRONT AND REAR
- GAS LINE TO REAR ONLY
- UNDERBELLY ALUMINUM
- HITCH DETACHABLE
- HITCH ORIENTATION STD
- AXLE 4TH
- MOVE E/C TO D/S WALL
- LED LIGHTS IN L/R CEILING INSTALL
- INSTALL OLD STYLE KITCHEN
- INSTALL 18" PANTRY IPO CABINET IN KITCHEN D/S
- D/S KITCHEN WINDOW TO BE 40X60
- EXCHANGE FURNACE AND CLOSET IN HALLWAY
- CLOSET IN HALLWAY BESIDE W/D
- BUNKROOM IN TIMBER RIDGE - DELETE
- MOVE BATHROOM FORWARD
- ADD WALK IN CLOSET TO BEDROOM
- MOVE WINDOWS BEHIND SOFA
- STRETCH BEDROOM FOR KING BED
- ONE ADDITIONAL CABINET COLOR - NAVY BLUE - LOWER KITCHEN CABINETS & ISLAND
- MORE THAN ONE ADDITIONAL CABINET COLOR - KITCHEN ISLAND BLUE / TRIMMED IN BLUE
- CABINET DOOR HARDWOOD CHAMFER SHAKER STYLE
- CABINET DRAWER GUIDES SELF CLOSING
- CABINET DOOR WITH SOFT CLOSING HINGES
- COUNTERTOP SOLID SURFACE W/SINK AND BACKSPLASH RIPE COTTON
- INTEGRATED SINKS

- BACKSPLASH UPGRADE SUBWAY TILE IN KITCHEN ULTRA WHITE
- CABINET KITCHEN LAZY SUSAN IN OHC
- WINDOW SILLS VINYL THRU OUT
- CABINET KITCHEN FULL DEPTH CAB OVER FRIDGE
- CABINET KITCHEN FINISH TOPSON OHC'S
- CHAIR RAIL THRU OUT
- TRIM AROUND ALL WINDOWS 1 3/4"
- MOLDING CROWN AROUND CABINETS - IRISH CAFE
- MOLDING INTERIOR BASE 3"
- CABINET BEDROOM STRAIGHT OHC
- CABINET BEDROOM CHEST OF DRAWERS
- VALANCE ABOVE CHEST
- CABINET BEDROOM 4 DOOR WARDROBES
- NIGHTSTANDS BUILD IN W/DOOR (2)
- CABINET ENTERTAINMENT BASE FOR 36" FIREPLACE
- CABINET BATH OVERHEAD TOILET
- CABINET BATH EXTEND LAV TOP OVER TOILET
- DOOR LOUVERED FOR FURNACE
- DOOR LOUVERED FOR W/D CLOSET
- SHELVES (4) ADJUSTABLE FOR CLOSET (NOT W/D)
- CABINET BATH OHC W/LIGHTED MIRROR
- WALL ACCENT SHIP LAP CROSS SAWN AT ENTERTAINMENT CENTER
- CABINET HARDWARE COLOR SATIN GOLD - THROUGH OUT
- FAUCET LAV BLACK MATTE
- FAUCET KITCHEN SINGLE HANDLE PULL DOWN BLACK MATTE
- SHOWER FIBERGLASS TUB 1 PC
- SHOWER WALL UPGRADE DUMAWALL WIND DUST
- SHOWER DOOR CLEAR GLASS FOR 1 PC TUB
- SHOWER DOOR WITH BLACK GRIDS
- SHOWER HEAD FIXED MATTE BLACK
- TOILET RESIDENTIAL
- VALVES WATER SHUT OFF FOR STANDARD FIXTURES
- FAUCET OUTSIDE WATER
- POWER BATH VENT W/ NO LIGHT IN VENT
- CEILING FAN
- 50 AMP
- TV / CABLE JACK (2)
- RECEPT GFI EXTERIOR (2)
- DIMMER SWITCH PER LIGHT
- LIGHTS LED W/DIMMER UNDER KITCHEN OHC
- LIGHTS LED W/DIMMER (3) BOTTOM OF BR OHC
- LIGHTS LED IN BEDROOM VALANCE
- LIGHTS LED IN CEILING
- LIGHT PORCH DARK BRONZE
- TV BRACKET WALL MOUNT FULL MOTION 32"-50" UP TO 80#
- TV LED 50"
- CO DETECTOR (CA)
- LP GAS DETECTOR (CA)
- FIREPLACE ELECTRIC 36"
- FURNACE 45,000 BTU HIGH EFFICIENCY
- A/C BOOT 12-2 WIRE W/SINGLE 20AMP BREAKER W/JBOX
- REFRIGERATOR FROST FREE 18 C.F. STAINLESS STEEL
- DISHWASHER 18" STAINLESS STEEL
- WASHER/DRYER PREP 110V W/CENTER SHELF
- RANGE GAS DELUXE W/ELECTRIC IGNITION STAINLESS STEEL
- WATER HEATER GAS/ELECTRIC 16 GAL W/DSI
- WATER HEATER LIGHTED SWITCH
- MICROWAVE OVER RANGE IPO STANDARD - VENT OUT SIDEWALL
- OMIT STAINLESS STEEL BACKSPLASH & RANGE HOOD
- DECOR COLOR SAND FURNITURE
- SOFA SLEEPER QUEEN DAWSON
- RECLINER WALL-A-WAY
- COFFEE TABLE ROUGH SAWN FARMHOUSE
- HEADBOARD WOODGRAIN
- BUNK W/ FOAM MATTRESS, TOP RAIL & BLACK LADDER
- KITCHEN ISLAND MOVABLE W/4 BAR STOOLS
- BED HYDRA LIFT KING
- DRAPE SIDE PANEL ACCENT
- BLIND FAUX WOOD WHITE
- SIDING VINYL UPGRADE MIDNIGHT SURF
- SHINGLES UPGRADE ARCH LIFETIME WARRANTY DUAL GRAY
- WINTERGUARD ROOF UNDERLAYMENT
- RADIANT FOIL ROOF
- SEAL CRVA - BUILD TO Z-241 CODE
- TABLE LAMP BLACK (2)
- END TABLE ROUGH SAWN FARMHOUSE (2)
- LIGHTS EAVE LED EXTERIOR (PR) - FRONT END
- LIGHT PENDANT BLACK CAGE (EA) - ISLAND (2)
- RECEPT USB (2)
- CABINET COLOR IRISH CAFE - TRIM - IRISH CAFE
- LOWER FASCIA (PER FT) - DOOR SIDE
- SIDE WALL EXTENSION (PER FT) - BUNKROOM, BATH AND BEHIND REFRIGERATOR
- DOOR PATIO THERMOPANE VINYL 6" INTERNAL BLIND
- DORMER SHED SINGLE - OVER BUNKROOM AND BATH