

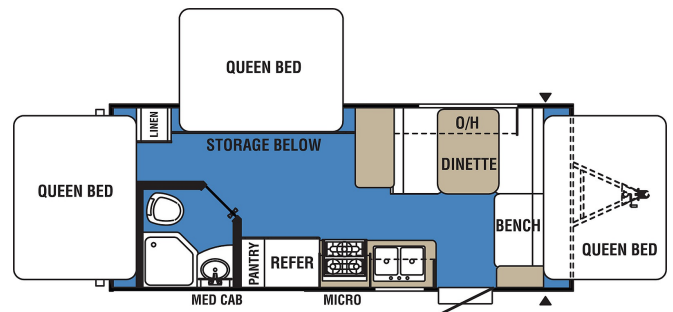

**SPECIAL UNIT**
**\$19,900.00**

Originally \$21,900

**\$102 Bi-Weekly**
**2020 COACHMEN CLIPPER 19TB**
**SPECIFICATIONS**

Year	2020
Manufacturer	COACHMEN
Brand	CLIPPER
Model	19TB
Type	Hybrid
Status	PreOwned
Stock #	8579
Financing Available	✓
Warranty Available	✓
Suspension	N/A
Leveling	N/A
Exterior Length	19.0 ft.
Dry Weight	4048 lbs.
Sleeping Capacity	8 person(s)
Interior Colour	N/A
Exterior Colour	Aluminum
Slideouts	N/A



**Disclaimer:** Product information, pricing and photos are as accurate as possible and are subject to change without notice.

**SELLING FEATURES**

THE LONGSTANDING TRADITION OF COACHMEN VALUE IN RECREATIONAL VEHICLES CONTINUES WITH THIS BRAND NEW LAYOUT IN THE CLIPPER 7' 6" WIDE TRAVEL TRAILER HYBRID.

DESIGNED TO GIVE A LITTLE EXTRA ROOM, THEY ARE 6 INCHES WIDER AND 4 FEET LONGER THAN THE 17 FOOT MODELS. FULLY EQUIPPED WITH ALL THE CREA...

Powered by focusRV